

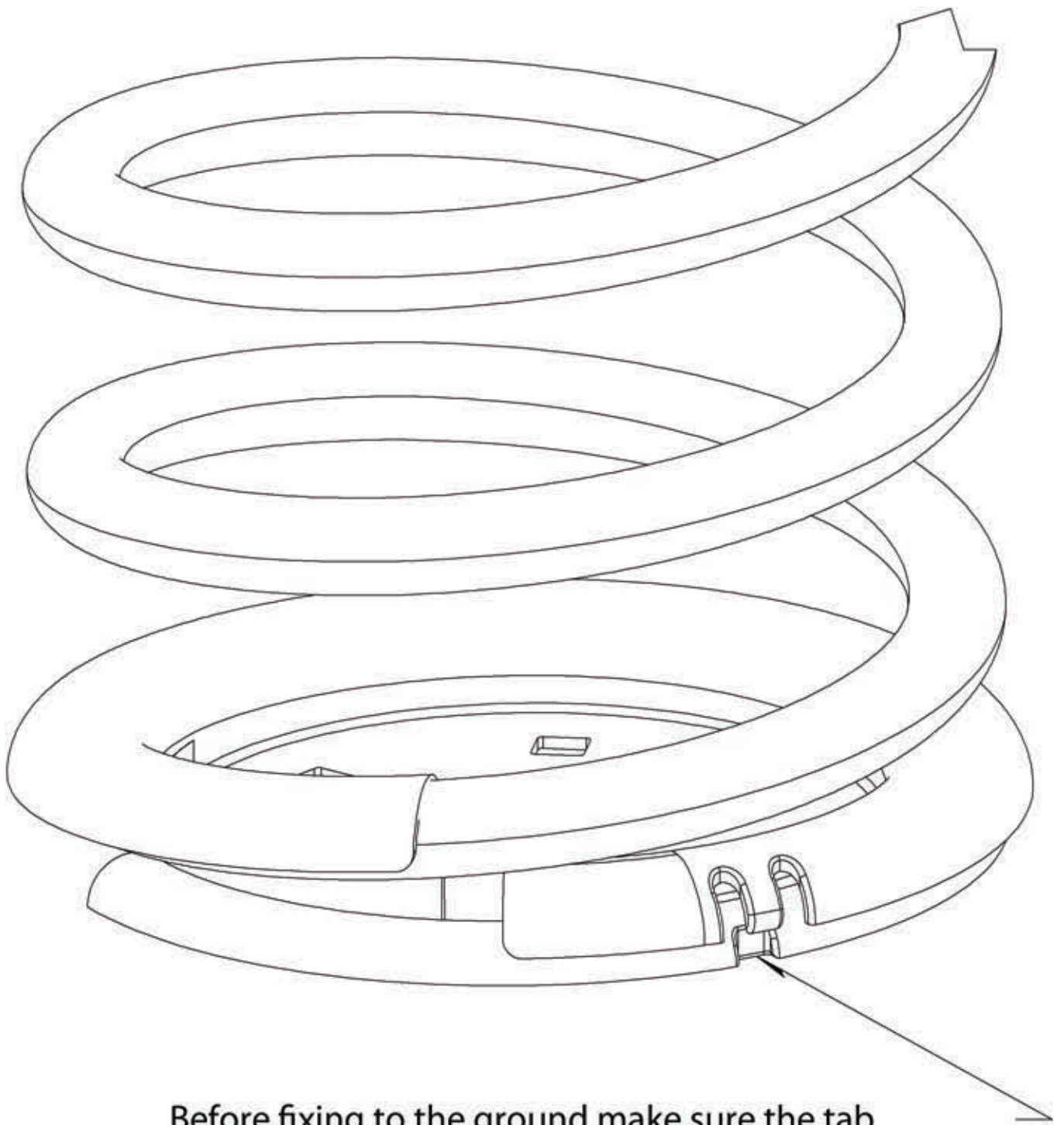

ASSEMBLY INSTRUCTIONS

SPRING RIDERS



Before fixing to the ground make sure the tab in the anchor plate is aligned with the throat in the spring, then proceed with ground fixing

Le misure del disegno sono espresse in	cm	HOLZHOFF	
Tolleranze generali applicate: *Sezione/diametro legname impregnato ± 0.5 (cm) *Lunghezza legname impregnato 1% (lung. totale) *Lavorazioni legname impregnato ± 0.2 (cm) *Componenti in metallo ± 1 (mm) *Componenti in altri materiali plastici ± 1.5 (mm)		denominazione	istruzioni di montaggio
		e/o cliente:	giochi a molla
			particolare aggancio molla e piastra
firma esecutore:	<i>Altieri</i>	data:	20.06.06
		nr.	pag.1

Bolt Down Installation		
Article Number	Quantity	Description
1	1	Pre-Assembled Spring Rider Body
2	1	Spring Anchor Plate
3	1	Foundation Base - Zinc Plated
4	3	Screw M10 x 30mm ISO8678
5	7	Locknut M10
6	7	Washer 10mm Diameter
7	4	Cap Polyethylene
8	4	Anchor Bolt M10

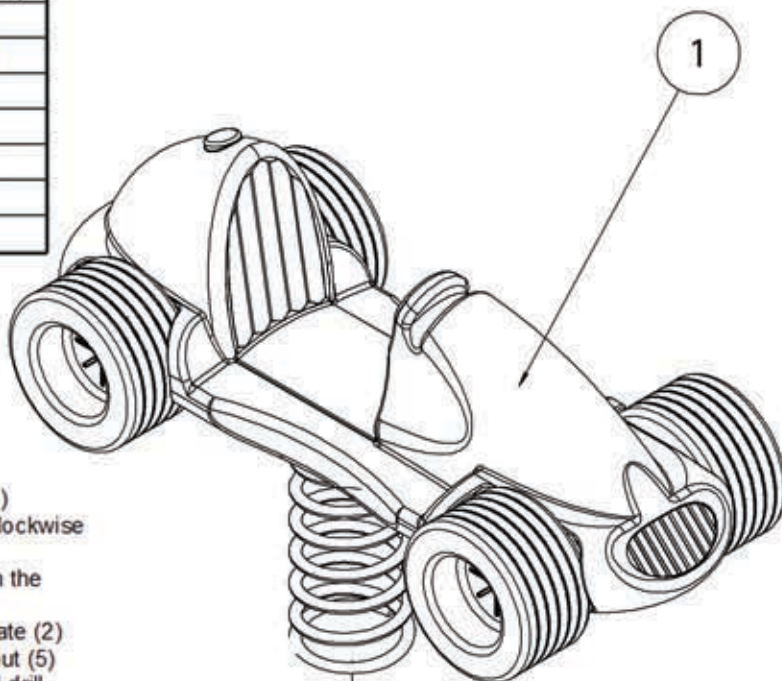

1. Place the Body Assembly (1) on the Foundation Base (3)
Spring should enter Spring Anchor Plate (2) by turning clockwise until Anchor Plate is aligned with throat in spring.
2. Now align the three holes in Spring Anchor Plate (2) with the corresponding holes in the Foundation Base (3)
3. Insert Screw (4) in the square holes of Spring Anchor Plate (2) fixing to Foundation Base (3) with Washer (6) and Locknut (5)
4. Mark location position on ground of Anchor Bolts (8) and drill suitable holes
5. Place spring toy assembly in corresponding position to holes and insert Anchor Bolts (8). Secure Anchor Bolts to Foundation Base (3) with Washers (6) and Locknuts (5)
6. Check solidity of Anchor Bolts (8) then affix Caps (7)

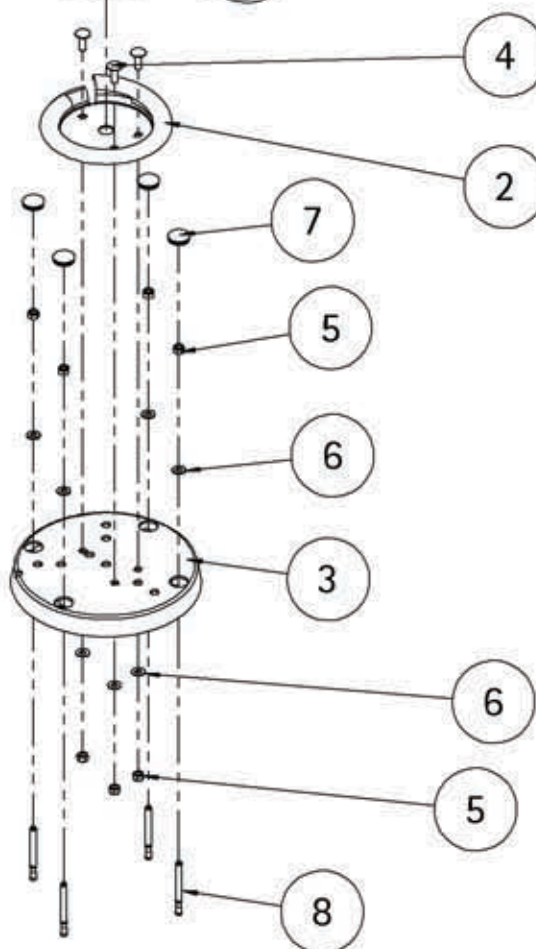

Note: Spring Toy pictured is indicative only and may be different from that supplied.
These installation instructions can be applied to all Holzhof Spring Toys.

Le misure del disegno sono espresse in cm		HOLZHOFF	
Tolleranze generali applicate: *Sezione/diametro legname impregnato ± 0.5 (cm) *Lunghezza legname impregnato 1% (lung. totale) *Lavorazioni legname impregnato ± 0.2 (cm) *Componenti in metallo ± 1 (mm) *Componenti in altri materiali plastici ± 1.5 (mm)		denominazione e/o cliente:	istruzioni di montaggio giochi a molla da appoggio
firma esecutore:	<i>Altieri</i>	data: 04.07.06	nr. pag.1

Inground Installation		
Article Number	Quantity	Description
1	1	Pre-Assembled Spring Rider Body
2	1	Spring Anchor Plate
3	3	Locknut M10
4	3	Washer 10mm Diameter
5	1	Foundation Base - Zinc Plated
6	3	Screw M10 x 30mm ISO8678

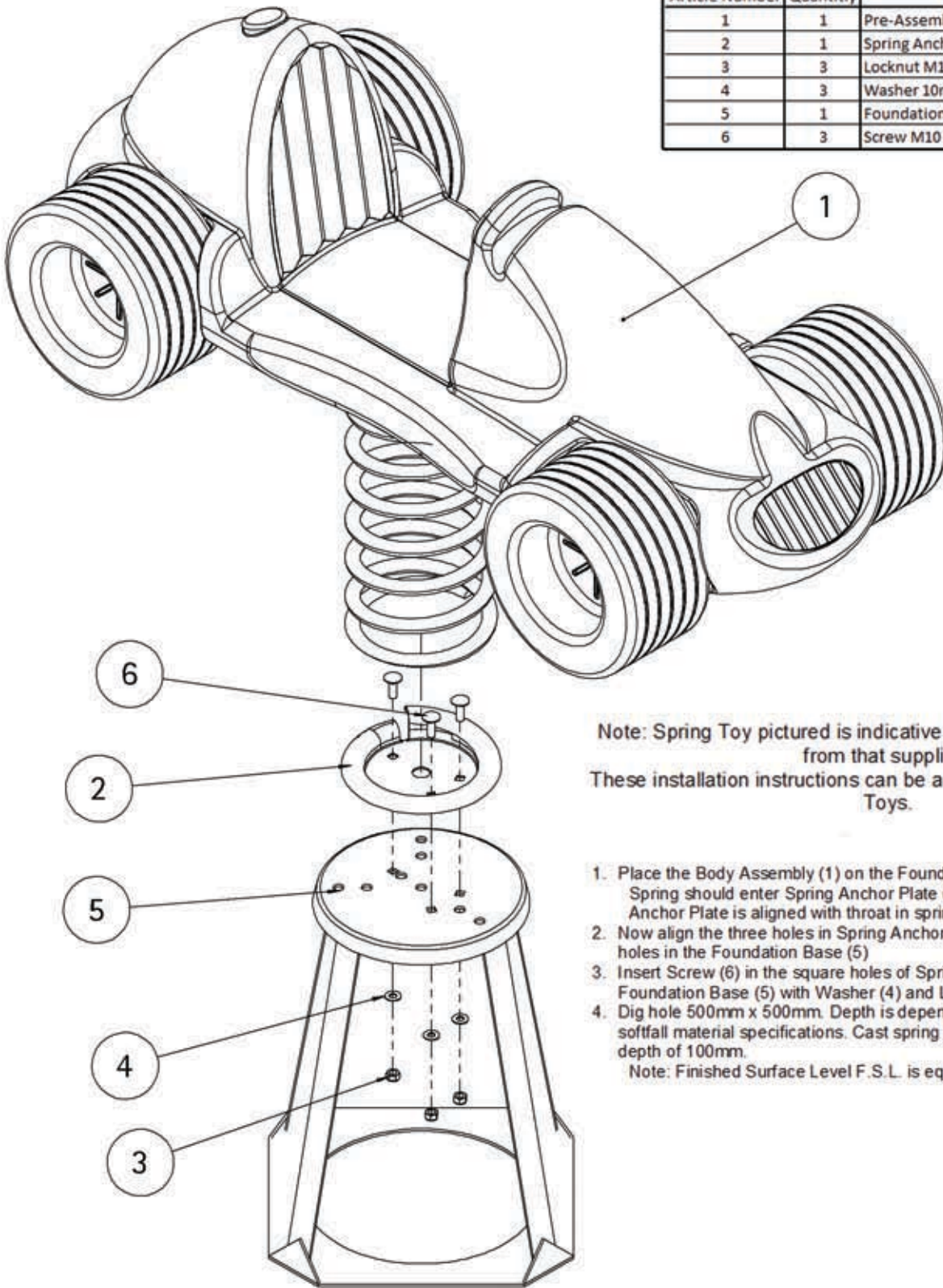

Note: Spring Toy pictured is indicative only and may be different from that supplied.
These installation instructions can be applied to all Holzhof Spring Toys.

1. Place the Body Assembly (1) on the Foundation Base (5)
Spring should enter Spring Anchor Plate (2) by turning clockwise until Anchor Plate is aligned with throat in spring.
2. Now align the three holes in Spring Anchor Plate (2) with the corresponding holes in the Foundation Base (5)
3. Insert Screw (6) in the square holes of Spring Anchor Plate (2) fixing to Foundation Base (5) with Washer (4) and Locknut (3)
4. Dig hole 500mm x 500mm. Depth is dependent on impact attenuation of softfall material specifications. Cast spring toy in concrete to a minimum depth of 100mm.

Note: Finished Surface Level F.S.L. is equal to top of Foundation Base (5)

Le misure del disegno sono espresse in cm		HOLZHOFF	
Tolleranze generali applicate: *Sezione/diametro legname impregnato ± 0.5 (cm) *Lunghezza legname impregnato 1% (lung. totale) *Lavorazioni legname impregnato ± 0.2 (cm) *Componenti in metallo ± 1 (mm) *Componenti in altri materiali plastici ± 1.5 (mm)		denominazione e/o cliente: istruzioni di montaggio giochi a molla da interro	
firma esecutore: <i>Altieri</i>	data: 05.07.06	nr.	pag.1